

# E31 SPARE PARTS LIST



Page2/3

## 1.1 MAIN ASSEMBLY

Pos	Part No.	Description
1	013054	WRAPPER
2	-----	INSULATION
3	013011	COVER PANEL
4	013012	COVER PANEL PLATE
5	011412	MICROSWITCH BRACKET
6	011389	MICROSWITCH INSULATOR
7	002990	MICROSWITCH
8	003012	ACTUATOR ROD
9	011414	VENT TUBE
10	003016	MOTOR MOUNTING PLATE
11	013431	MOTOR
12	012782	HOSE CONNECTOR
13	011634	ELBOW
14	012781	SOLENOID VALVE
15	019208	SOLENOID MOUNTING BRACKET
16	012784	SOLENOID EXTENSION
17	012785	INJECTOR
18	011404	L.H OVEN SUPPORT
19	013586	TERMINAL BLOCK
20	002138	CABLE CLAMP
21	002441	INSULATOR
22	018251	CABLE ENTRY CLAMP BRACKET
23	013053	BODY
24	013908	FOOT ASSEMBLY - 1" (25 mm)
	013048	LEG - 4" (100 mm)
25	004594	COUNTERWEIGHT (UK ONLY)
26	017770	PHIAL GUARD
27	004004	OVEN INNER
28	011413	R.H OVEN SUPPORT
29	011407	SIDE INSULATION PANEL
30	013520	OVEN LIGHT ASSEMBLY
	003002	LIGHT GLASS
	003434	SILK GASKET
	013521	LAMP 40W
31	013432	FAN
32	004005	FAN BAFFLE (ALL MARKETS EXCEPT UK)
	004595	FAN BAFFLE (UK ONLY)
33	003123	BAFFLE BRACKET
34	011604	TOP ELEMENT 230 - 240V (USA/CANADA 220-240V)
	003113	TOP ELEMENT 208 - 220V (USA/CANADA 208V)
35	003074	BOTTOM ELEMENT 230 - 240V (USA/CANADA 220-240V)
	003114	BOTTOM ELEMENT 208 - 220V (USA/CANADA 208V)
36	003219	ELEMENT SUPPORT
37	002083	SCONE TRAY (UK ONLY)
38	012809	OVEN RACK

# E31 SPARE PARTS LIST



Page3/3

## 1.1 MAIN ASSEMBLY

Pos	Part No.	Description
39	003382	OVEN SIDE RACK (ALL MARKETS EXCEPT USA/CANADA )
	012798	OVEN SIDE RACK (USA/CANADA ONLY)
40	012787	WATER TROUGH
41	003057	BOTTOM ELEMENT GUARD
42	018970	OVEN SEAL (1 PIECE - FROM S/N 24957)
	018031	OVEN SEAL (1 PIECE CONTINUOUS - FROM JUNE 1994 TO S/N 24956 (NOT ILLUSTRATED)(SEAL KIT UPGRADE TO 018970 AVAILABLE)
	014226	OVEN SEAL - HORIZONTAL (2 PER - TO JUNE 1994)(NOT ILLUSTRATED)
	014225	OVEN SEAL - VERTICAL (2 PER - TO JUNE 1994)(NOT ILLUSTRATED)
43	018033	SEAL RETAINING CLIP (USED WITH 018970 / 018031 SEALS)
44	004061	PIVOT COVER - TOP
45	011422	PIVOT SUPPORT - TOP ASSEMBLY
46	011395	TOP TRIM
47	004006	DOOR INNER
48	014120	HANDLE BRACKET (HANDLE ASSEMBLY 014600)
49	013892	HANDLE (HANDLE ASSEMBLY 014600)
50	-----	CONTROL ASSEMBLY (SEE SECTION 1.2)
51	011396	BOTTOM TRIM
52	013610	DOOR BUSH (ALSO USED ON CONTROL PANEL PIVOT)
53	011424	PIVOT SUPPORT - BOTTOM ASSEMBLY
54	002340	DOOR INNER GLASS
55	004452	DOOR GLASS CLAMP ANGLE
56	013050	DOOR OUTER GLASS

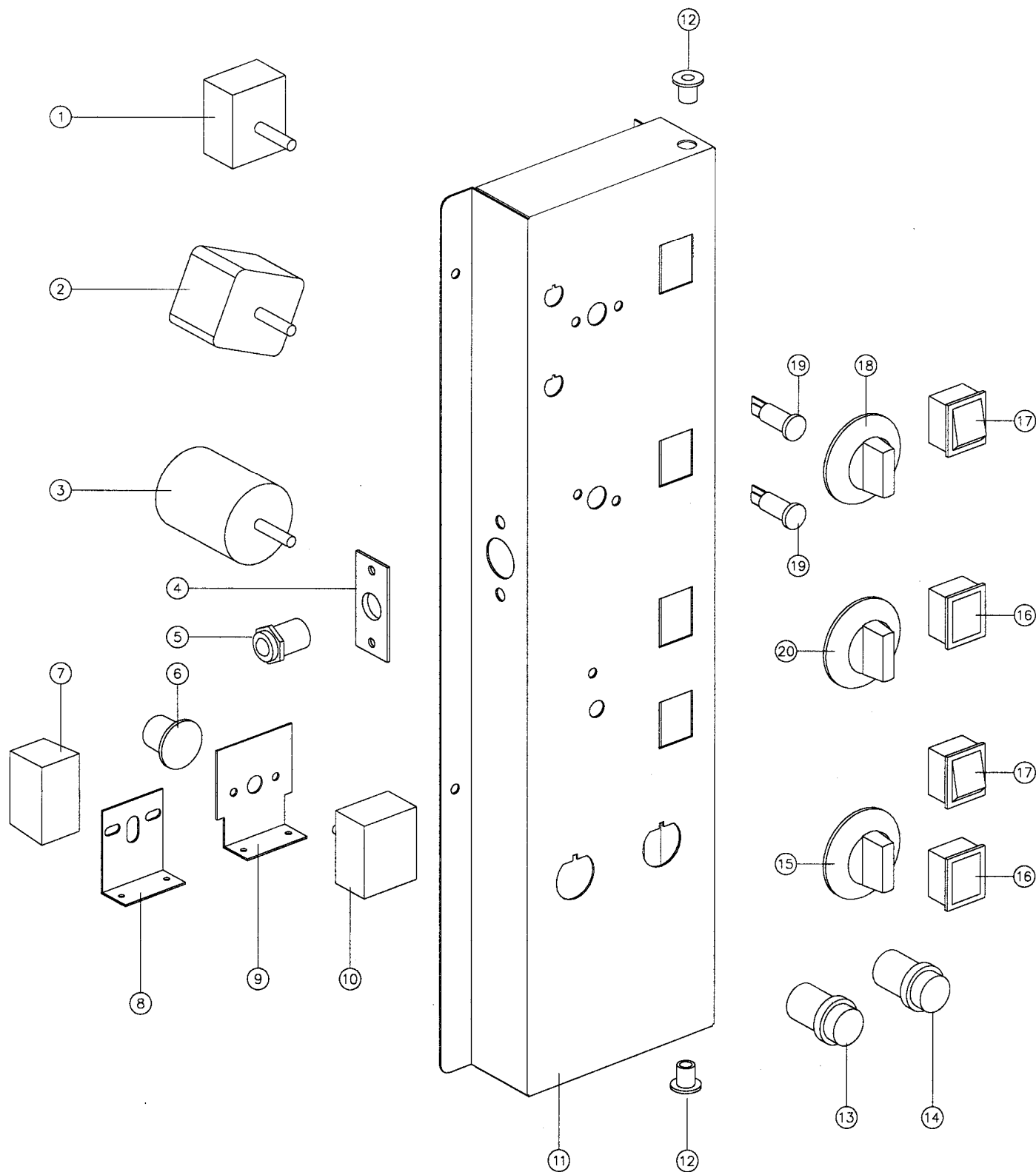

Pos	Part No.	Description
1	017121	THERMOSTAT 50-300 °C
2	011760	TIMER - 1 Hr
3	011419	TIMER - 3 Hr (240V 50 Hz)
	011983	TIMER - 3 Hr (240V 60 Hz)
4	016402	BALL CATCH PLATE
5	011005	BALL CATCH & LOCKNUT
6	018224	HOLD THERMOSTAT KNOB
7	011794	BUZZER
8	014032	BUZZER MOUNTING BRACKET
9	017859	HOLD THERMOSTAT BRACKET (AFFIX 018209 LABEL)
10	018223	HOLD THERMOSTAT
11	004447	CONTROL PANEL
12	013610	DOOR BUSH
13	012895	WATER SWITCH (BLUE BUTTON)
14	013891	LIGHT SWITCH (ORANGE BUTTON)
15	015567	TIMER KNOB - 3 Hr
16	013542	INDICATOR LIGHT
17	013543	ON/OFF & START SWITCH
18	017531	KNOB °C
	017519	KNOB °F
19	013528	PILOT LIGHT
20	015560	TIMER KNOB - 1 Hr